

**LEGEND**

- EXISTING GROUND MOUNTED BARRIER
- PROPOSED GROUND MOUNTED BARRIER
- EXISTING CONIFEROUS TO BE REMOVED  
SEE TABLE FOR SIZE AND TYPE
- EXISTING DECIDUOUS TO BE REMOVED  
SEE TABLE FOR SIZE AND TYPE
- RETENTION OR REMOVAL TO BE DETERMINED ON SITE
- EXISTING CONIFEROUS TO REMAIN
- PROPOSED 1.0m HT DECIDUOUS SHRUBS



CONT No 2007-XXXX  
WP No 4010-05-00

LANDSCAPE INVENTORY  
AND TREATMENT

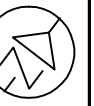

SHEET  
8

Survey \_\_\_\_\_ Revised \_\_\_\_\_  
**THE GREER GALLOWAY GROUP INC.**  
ENGINEERS + PLANNERS  
PETERBOROUGH BELLEVILLE

**HEARTLAND ENVIRONMENTAL DESIGN**  
LANDSCAPE ARCHITECTS ENVIRONMENTAL DESIGNERS  
STERLING ONT.

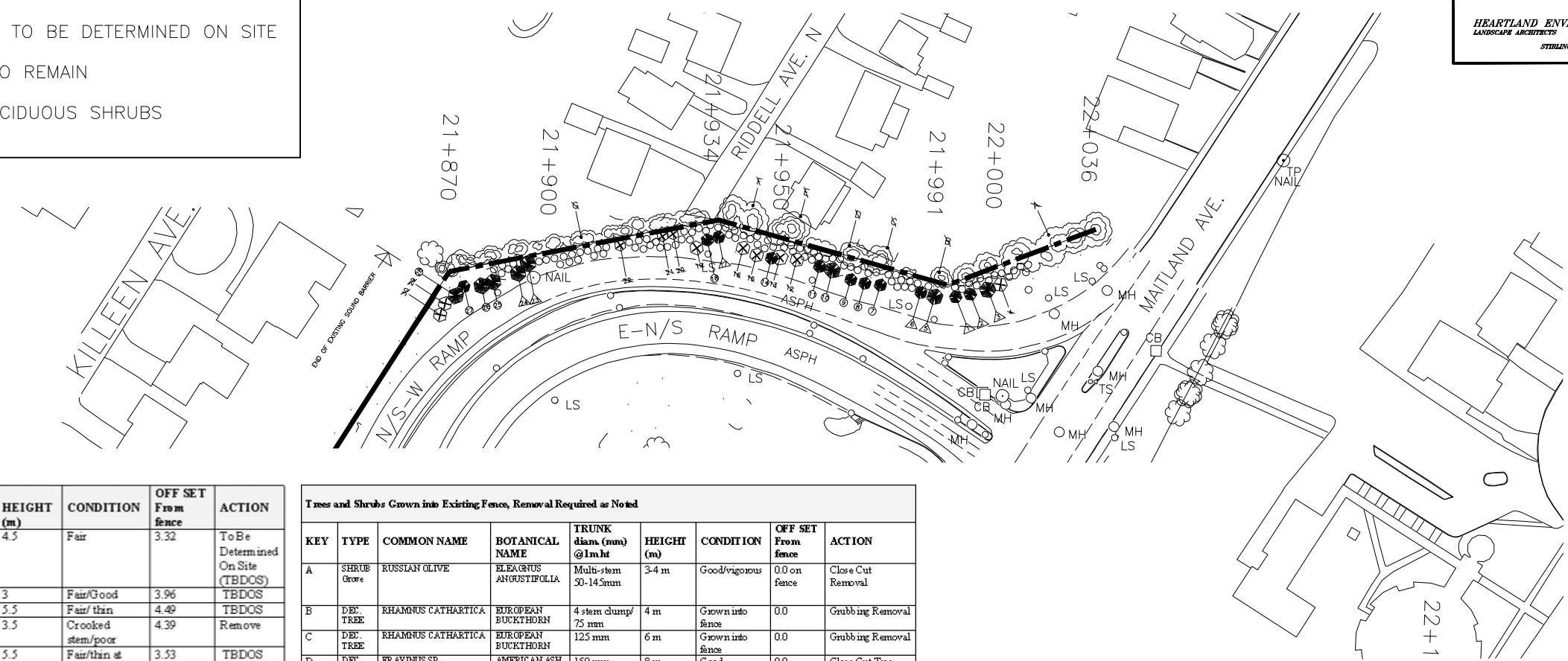

**VEGETATION MANAGEMENT TABLE**

KEY	TYPE	COMMON NAME	BOTANICAL NAME	TRUNK diam. (mm) @ 1m ht	HEIGHT (m)	CONDITION	OFF SET From fence	ACTION
1	CONIF. TREE	COLORADO BLUE SPRUCE	PICEA PUNGENS GLAUCA	130	4.5	Fair	3.32	To Be Determined On Site (TBDOS)
2	"	"	"	100	3	Fair/Good	3.96	TBDOS
3	"	"	"	130	5.5	Fair/thin	4.49	TBDOS
4	"	"	"	100	3.5	Crooked stem/poor	4.39	Remove
5	"	"	"	145	5.5	Fair/thin at base	3.53	TBDOS
6	"	"	"	100	4	Fair/thin at base	3.53	TBDOS
7	"	"	"	65	4	Fair/thin at base	4.50	Keep
8	"	"	"	130	4	Fair/thin at base	5.15	Keep
9	"	"	"	100	4	Fair/thin at base	5.25	Keep
10	"	"	"	100	5	Fair	4.34	Keep
11	"	AUSTRIAN PINE	PINUS NIGRA	75	3	Fair	4.34	Keep
12	"	"	"	50	2.5	Poor/stunted	4.34	Remove
13	"	"	"	130	5	Fair/broken leader	4.41	Remove, Fire Access Conflict
14	"	"	"	130	4	Fair	5.10	Keep
15	"	"	"	100	3.5	Fair	5.30	Remove
16	"	"	"	130	4	Fair	4.44	Remove
17	"	COLORADO BLUE SPRUCE	PICEA PUNGENS GLAUCA	65	3.5	Fair	4.0	TBDOS
18	"	"	"	75	3.5	Fair/Good	4.16	Keep
19	"	"	"	65	3	Poor/Twisted	5.54	Remove
20	"	"	"	75	4	Fair	1.27	Remove
21	CONIF. TREE	COLORADO BLUE SPRUCE	PICEA PUNGENS GLAUCA	75	4	Fair	1.30	Remove
22	"	AUSTRIAN PINE	PINUS NIGRA	100	3	Fair/Poor	1.52	Remove
23	"	"	"	75	5	Good	1.72	TBDOS
24	"	COLORADO BLUE SPRUCE	PICEA PUNGENS GLAUCA	100	6	Fair/thin	3.5	TBDOS
25	"	"	"	150	7	Good	4.4	Keep
26	"	"	"	150	7	Good	4.77	Keep
27	"	"	"	75	4.5	Fair/thin	4.14	Keep
28	"	AUSTRIAN PINE	PINUS NIGRA	150	7	Good	4.47	Keep
29	"	"	"	100	4	Fair	3.35	Remove
30	"	"	"	150	3	Fair/stunted	3.83	Remove

**Trees and Shrubs Grown into Existing Fence, Removal Required as Noted**

KEY	TYPE	COMMON NAME	BOTANICAL NAME	TRUNK diam. (mm) @ 1m ht	HEIGHT (m)	CONDITION	OFF SET From fence	ACTION
A	SHRUB GROVE	RUSSIAN OLIVE	ELEAGNUS ANGUSTIFOLIA	Multi-stem 30-145mm	3-4 m	Good/vigorous	0.0 on fence	Close Cut Removal
B	DEC. TREE	RHAMNUS CATHARTICA	EUROPEAN BUCKTHORN	4 stem clump/ 75 mm	4 m	Grown into fence	0.0	Grubbing Removal
C	DEC. TREE	RHAMNUS CATHARTICA	EUROPEAN BUCKTHORN	125 mm	6 m	Grown into fence	0.0	Grubbing Removal
D	DEC. TREE	FRAXINUS SP.	AMERICAN ASH	150 mm	8 m	Good	0.0	Close Cut Tree Removal
E	DEC. TREE	ULNUS AMERICANA	AMERICAN ELM	400 mm	15 m	Fair/Good	0.0	Close Cut Tree Removal
F	DEC. TREE	ULNUS AMERICANA	AMERICAN ELM	2 stems 300 mm each	15 m	Fair/weak structure	0.0	Close Cut Tree Removal
G	SHRUB GROVE	HONEYSUCKLE	LONICERA	Thicket	2-3 m	Grown along and into fence	0.0	Close Cut Removal

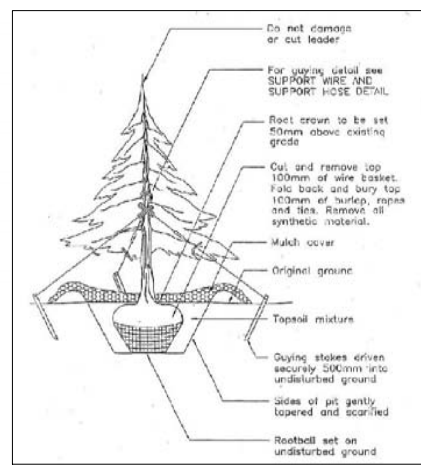

**CONIFEROUS PLANTING DETAIL D1**  
1.5m AND LARGER

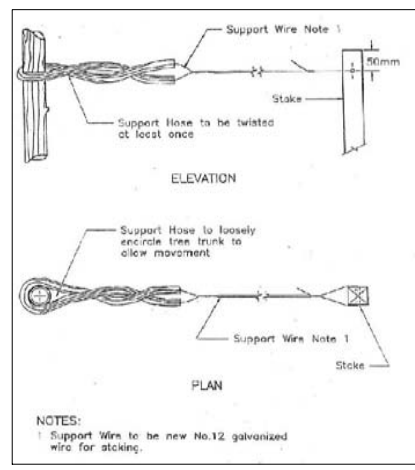

**SUPPORT WIRE AND SUPPORT HOSE DETAIL D2**

**NEW PLANTING TABLE**

New coniferous trees and deciduous shrubs to be planted following wall installation. Plant as directed by Landscape Architect.

Quantity	Botanical Name	Common Name	Size	Condition	Notes
15	Picea Pungens	Colorado Spruce	1.5m HT	Container, WB or B&B	Fit planted and per DI. Not shown on plan for clarity
5	Picea Omonka	Serbian Spruce	1.5m HT	Container, WB or B&B	Fit planted and per DI. Not shown on plan for clarity
40	Salix Caprea Discolor	Pussy Willow	1.0m HT	5 gallon container	Fit planted min 1m from Barrier and among new and existing conifers
40	Sambucus Canadensis Aurea	Golden Elder	1.0m HT	5 gallon container	Fit planted min 1m from Barrier and among new and existing conifers
10	Myrica Pennsylvanica	Bayberry	1.0m HT	5 gallon container	Fit planted min 1m from Barrier and among new and existing conifers

NOTES:  
1 Support Wire to be new No.12 galvanized wire for staking.